

Fixtures

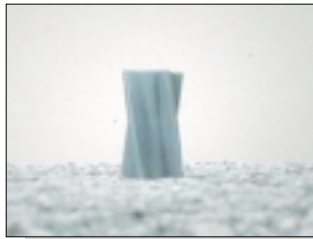

Cabinets and Fixtures

As in conventional construction, cabinets and fixtures can be attached to PERFORM WALL™ panels. For items up to approximately 50 lbs per bolt, small hollow anchors can be used.



GB-plastic anchors can be used without drilling, and can be just hammered in. Sizes are 3/8," 7/16," and 9/16." 9/16" anchor hold up to 100 lbs (centric tension was tested with 313 lbs). Higher load capacities can be attained by drilling a hole smaller than the anchor by 1/16" and filling it with binder (foam), then pushing in the anchor.

Threaded Bolts for Heavier Items

For heavier items threaded steel bolts or rods can be used. First, drill a hole slightly larger than the diameter of the bolt (1 mm – 1/16"), fill the hold with binder (foam), and insert the bolt. Bolts should be embedded a minimum of 100 mm 4." Another alternative would be to drill into the concrete core at 15" on center and glue an anchor, using concrete epoxy glue. Once set, the strength of this material can match that of the actual concrete.

Backing Strips

Another alternative for heavier fixtures such as kitchen cabinets is to attach them via a wooden backing strip. To set backing into the PERFORM WALL™ panels, simply route out the face of the PERFORM WALL™ panel to the depth of the backing, typically, this will be a 2" x 4." The furring is glued to the panels face and nailed to the concrete core. The wooden backing set into the surface of the wall can later be covered by sheetrock or plastered over. Screws can then be used to attach the fixture or cabinet to the wall.

Garage Doors

One method of installing garage doors is to use surface mounted 2" x 6" or 2" x 8" or larger with anchor bolts embedded in the concrete cores.

Kitchen or Bath Cabinets

Kitchen or bath cabinets can also be installed using a 2" x 4" routed into the surface at three locations: top of the wall cabinets, bottom of wall cabinets and top of base cabinets. For cabinet backing _" anchor bolts can be placed at 48" on center along and gluing them in with the same foam glue used to glue the PERFORM WALL™ panels together. Alternatively, a nailer system can be used, whereby, before grouting the wall, 2" x 4" strips are pre-nailed with 3" x 3/16" penny nails at 15" on center and then glued into a routed groove 1-3/4" deep. At 15" on center, the penny nails protrude into the cells and are firmly secured upon grouting. Cabinets can then be fixed to the nailer strips. The advantage to this approach is that measuring to find studs for securing the strips into the wall cells is eliminated.

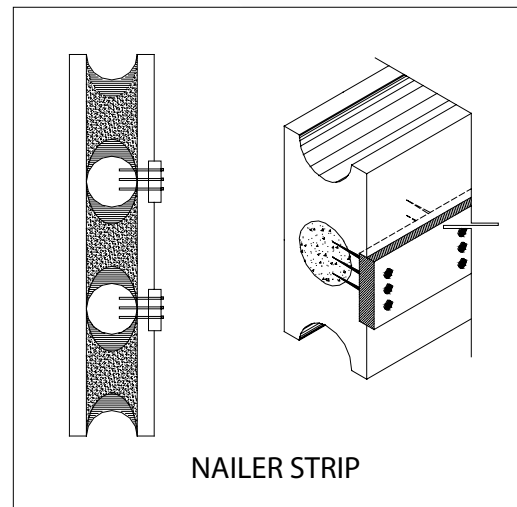

For other types of backing, all that is needed is to route out the face of the PERFORM WALL™ panels and glue the wood backing to them using a foam adhesive. Remember to mark on the blueprint where the backing was placed so it can be found later on after the wall has been finished.